

■ **PLUG EXTENDER / RACCORD RAPIDE AVEC EXTENSION FILETÉE**
VERLÄNGERUNGSNIPPEL

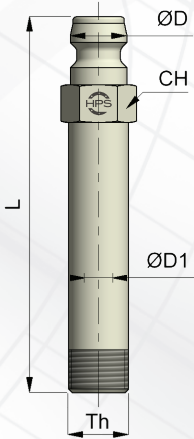

Th (BSP)	Ø D	Ø D1	L (to select)	CH	Part-number
1/8	9	6	60/100/150	11	PGH819G18100
1/4	9	6	60/100/150	14	PGH819G14100
3/8	9	6	60/100/150	17	PGH819G38100
1/8	13.5	9	60/100/150	14	PGH813G18100
1/4	13.5	9	60/100/150	14	PGH813G14100
3/8	13.5	9	60/100/150	17	PGH813G38100
1/2	13.5	9	60/100/150	21	PGH813G12100
1/2	19	13	250/500/800	22	PGH8119G12500
3/4	19	13	250/500/800	27	PGH8119G34500



Change the end of the reference to one of the optional lengths.
 Veuillez modifier svp la fin de la référence par l'une des dimensions disponibles.
 Ändern Sie bitte die letzten 3 Stellen bei der Referenz für die gewünschte Länge

■ **90° PLUG / 90° RACCORD RAPIDE / 90° WINKELNIPPEL**

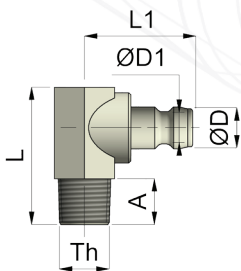

Th (BSPT)	Ø D	Ø D1	L	L1	A	Part-number
1/8	9	6	27	23	9	PGH819L1890
1/4	9	6	34	27.5	12	PGH819L1490
3/8	9	6	34	23	12	PGH819L3890
1/4	13.5	9	34	24.5	12	PGH813L1490
3/8	13.5	9	34	27	12	PGH813L3890
1/2	19	13	47	42	15	PGH8119L1290

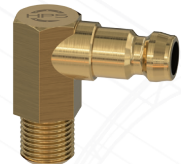

■ **EXTENSION TUBE / TUBE EXTENSION / VERLÄNGERUNGSROHR**

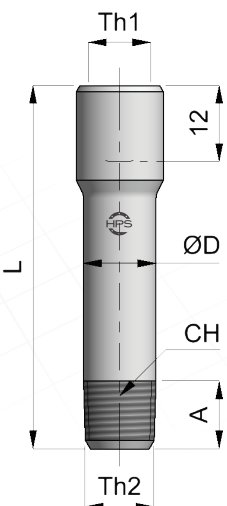

Th1 (BSP)	Th2 (BSPT)	Ø D	L	A	CH	Part-number
1/8	1/8	10	50	10	5	BU18R1850
1/8	1/8	10	75	10	5	BU18R1875
1/8	1/8	10	100	10	5	BU18R18100
1/8	1/8	10	125	10	5	BU18R18125
1/4	1/4	14	50	11	8	BU14R1450
1/4	1/4	14	75	11	8	BU14R1475
1/4	1/4	14	100	11	8	BU14R14100
1/4	1/4	14	125	11	8	BU14R14125
1/4	1/4	14	150	11	8	BU14R14150

