

FULL FLOW / DÉBIT LIBRE FREIER DURCHGANG



Temperature Range:
-20°C +100°C (-4°F +212°F)

Working Pressure:
0 - 10 bar (0-145 PSI)

Flow Size:
HPS 25 25 mm
HPS 33 33 mm
HPS 50 50 mm

Standard Version:
FullFlow
Chrome Plated
Seals - Nitrile (NBR)

Material:
Coupler Body - Brass Chrome Plated
Back Part - Brass Chrome Plated
Sleeve - Brass Chrome Plated
Springs - Stainless Steel
Locking O-Ring - Stainless Steel
Balls - Stainless Steel
Seals - Nitrile (NBR)
Plug - Stainless Steel (AISI 420)

Options:
Seal - Ethylene (EPDM)
Seal - Viton (NBR)

Température d'utilisation:
-20°C +100°C (-4°F +212°F)

Pression d'utilisation:
0 - 10 bar (0-145 PSI)

Passage:
HPS 25 25 mm
HPS 33 33 mm
HPS 50 50 mm

Version Standard:
Passage Libre
Chrome
Joint - Nitrile (NBR)

Matière:
Corps de Coupleur - Laiton Chromé
Raccordement Arrière - Laiton Chromé
Bague - Laiton Chromé
Ressort - Acier Inoxydable
Cage de Joint - Acier Inoxydable
Billes - Acier Inoxydable
Joint - Nitrile (NBR)
Embout - Acier Inoxydable (AISI 420)

Options:
Joint - Ethylene (EPDM)
Joint - Viton (NBR)

Temperaturbereich:
-20°C +100°C (-4°F +212°F)

Betriebsdruck:
0 - 10 bar (0-145 PSI)

Nennweiten:
HPS 25 25 mm
HPS 33 33 mm
HPS 50 50 mm

Standardversion:
Feier Durchfluss nicht absperrbar.
verchromt
Dichtungen - Nitril (NBR)

Material:
Kupplungsgrundkörper - Messing verchromt
Hinterteil - Messing verchromt
Hülse - Messing verchromt
Federn - Edelstahl
Sprengtring - Edelstahl
Kugeln - Edelstahl
Dichtungen - Nitril (NBR)
Nippel - Edelstahl (AISI 420)

Optionen:
Dichtungen - Ethylen-Propylen-Dien-Kautschuk (EPDM)
Dichtungen - Viton (NBR)

FULL FLOW QUICK COUPLINGS FEMALE COUPLINGS RACCORD RAPIDE FEMELLE PASSAGE LIBRE KUPPLUNG INNENGEWINDE

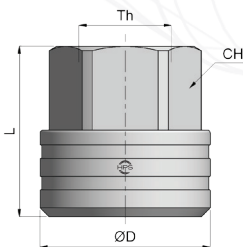

Th (BSP)	Ø D	L	CH	Part-number
1"	57	57	46	FC25G100
1" 1/4	65	62	55	FC33G114
2"	89	70	77	FC50G200



FULL FLOW QUICK COUPLINGS MALE COUPLINGS RACCORD RAPIDE MÂLE PASSAGE LIBRE NIPPEL INNENGEWINDE

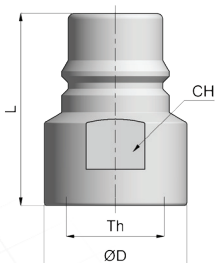

Th (BSP)	Ø D	L	CH	Part-number
1"	45	61	41	MC25G100
1" 1/4	55	66	50	MC33G114
2"	75	78	71	MC50G200



COUPLINGS UNION / RACCORD DOUBLE MÂLE / DOPPELNIPPEL

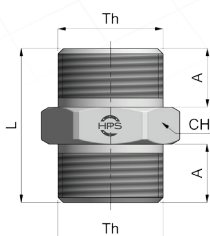

Th (BSP)	L	A	CH	Part-number
1"	42	17.5	36	HMM1010
1" 1/4	52	21	50	HMM114114
2"	65	25	70	HMM2020

